

## MODELLI / MODELS

- 4 Rebecca
- 8 Anita
- 12 Elena
- 16 Luisa
- 20 Onelia Laccata
- 24 Onelia Noce
- 28 Beatrice

## MANIGLIE - STRUTTURE / HANDLES - STRUCTURES

- 32 Maniglie di serie / Standard handles
- 33 Maniglie vintage / Vintage handles
- 34 Maniglie artigianato artistico / Artistic craft handles
- 36 Colori effetto Muro / Wall-effect colours
- 38 Cornici ante vetro / Glass door frames
- 39 Strutture Pensili - basi e cassoni / Wall-unit Structures - base units and carcasses
- 40 Cerniere e zoccoli / Hinges and plinths
- 41 Maggiorazioni fuori misura / Surcharges for custom sizes

## PENSILI - SCOLAPIATTI /

## WALL UNITS - DISH DRAINER UNITS

- 44 Pensili / Wall units
- 54 Scolapiatti / Dish drainer units
- 61 Pensili folding / Folding wall units
- 62 Piattaie / Plate racks
- 63 Boiserie Dream / Dream Boiserie

## CAPPE / HOODS

- 66 Cappe camino / Chimney hoods

## BASI / BASE UNITS

- 82 Basi / Base units
- 89 Basi angolo / Corner base units
- 90 Basi forno / Oven base units
- 91 Basi sottolavello / Sink base units
- 94 Basi elettrodomestici / Appliance base units
- 98 Basi forno - muretto / Oven base units - low wall

## ELEMENTI SOPRAPIANO / ABOVE-WORKTOP ELEMENTS

- 100 Elementi sopra piano / Above-worktop elements
- 104 Elementi sottopensili / Under-wall unit elements
- 105 Madia - Elementi sopra piano / Sideboard - Above-worktop elements

## COLONNE DISPENSA / CUPBOARD COLUMNS

- 106 Colonne dispensa / Cupboard columns
- 114 Colonne terminali / End columns
- 116 Colonne frigo e dispensa / Cupboard and fridge columns

## COLONNE FORNO / OVEN COLUMNS

- 118 Colonne forno / Oven columns
- 127 Colonne forno e microonde / Oven and microwave columns
- 128 Colonne forno / Oven columns
- 132 Colonne forno e microonde / Oven and microwave columns

## COLONNE FRIGO / FRIDGE COLUMNS

- 134 Colonne frigo / Fridge columns
- 144 Colonne frigo free-standing / Free-standing fridge columns
- 146 Maggiorazioni per colonne / Surcharges for columns
- 149 Tipologie nicchie / Niche types

ELEMENTI EFFETTO MURO - ELEMENTI A GIORNO /  
WALL-EFFECT ELEMENTS - OPEN UNITS

- 150 Elementi effetto muro / Wall-effect elements
- 154 Elementi a giorno / Open units
- 158 Accessori / Accessories

## PENISOLE - LIVING / PENINSULAS - LIVING ROOM

- 162 Penisole / Peninsulas
- 168 Living - mobili di completamento / Living room - accessory cabinets
- 170 Living / Living room
- 178 Living / Living room

## COMPOSIZIONI TIPO / TYPICAL COMPOSITIONS

- 184 Composizioni tipo / Typical compositions
- 194 Condizioni di vendita / Conditions of sale

**CARATTERISTICHE TECNICHE****Anta pannello liscio**

Pannello in listellare impiallacciato di rovere spazzolato nei colori: Rovere Naturale (opz. 170) Rovere Bianco Pietra (opz. 171) Rovere Tabacco (opz. 172) Rovere Fango (opz. 173) spessore 24 mm

**Anta vetro**

Telaio in massello di rovere spazzolato spessore 24 mm con i seguenti vetri:

- **di serie:** Vetro Anticato spessore 4 mm (opz. V15);
- **a richiesta:** Vetro Gotik spessore 4 mm (opz. V20);
- **a richiesta:** Vetro Master Carrè spessore 4 mm (opz. V25).

**Struttura pensili**

In listellare impiallacciato spessore 25 mm finitura come anta.

**Struttura cappe**

Fascione in rovere spazzolato, camino in multistrato di pioppo finitura effetto muro (vedi colori effetto muro pag. 36).

**Struttura basi e colonne**

Frontale e parti a vista in multistrato di pioppo finitura effetto muro (vedi colori effetto muro pag. 36). Cassone in listellare laminato oak, spessore 18 mm (opz. 110) o in listellare laminato twist, spessore 18 mm (opz. 115).

**Struttura cassette e cestoni**

In massello di faggio naturale con guide estrazione totale sistema blumotion.

**Mensole**

In listellare impiallacciato di rovere, finitura come anta.

**Zoccolo**

Impiallacciato finitura come anta h 10 cm

**TECHNICAL FEATURES****Door with smooth panel**

Panel in blockboard with brushed oak veneer in the following colours: Natural Oak (opt. 170) Stone White Oak (opt. 171) Tobacco Oak (opt. 172) Mud Oak (opt. 173) thickness: 24 mm

**Glass door**

Frame in solid brushed oak

24 mm thick, with the following glass:

- **standard:** Antique-effect glass, 4 mm thick (opt. V15);
- **on request:** Gothic glass, 4 mm thick (opt. V20);
- **on request:** Master Carrè glass, 4 mm thick (opt. V25).

**Wall unit structure**

In veneered blockboard, 25 mm thick same finish as door.

**Hood structure**

Band in brushed oak, chimney in poplar plywood with wall-effect finish (see wall-effect colours on page 36).

**Columns and base unit structures**

Front panel and visible parts in poplar plywood with wall-effect finish (see wall-effect colours on page 36).

Carcass in blockboard with oak veneer, thickness: 18 mm (opt. 110) or in blockboard with twist veneer, thickness: 18 mm (opt. 115).

**Structures for drawers and deep drawers**

In solid natural beech with full extraction runners with blumotion system.

**Shelves**

In blockboard with oak veneer, same finish as doors.

**Plinth**

Veneer, same finish as doors h 10 cm



**ANTE  
DOORS**



Rovere Naturale (opz. 170)  
Natural Oak (opt. 170)



Rovere Bianco Pietra (opz. 171)  
Stone White Oak (opt. 171)



Rovere Tabacco (opz. 172)  
Tobacco Oak (opt. 172)



Rovere Fango (opz. 173)  
Mud Oak (opt. 173)

**ANTE GRATA LEGNO  
DOORS WITH GRATING WOOD**



Rovere Naturale (opz. 170)  
Natural Oak (opt. 170)

**ANTE GRATA FERRO  
DOORS WITH GRATING IRON**

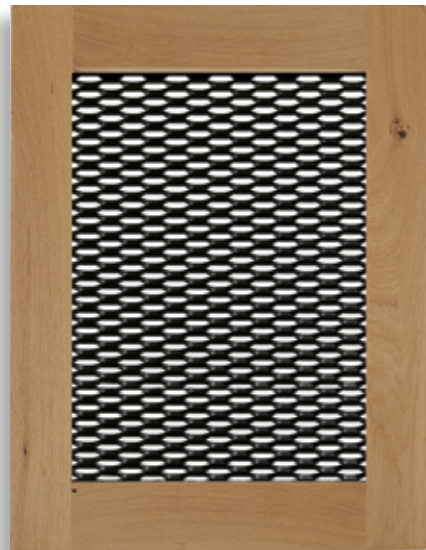

Rovere Naturale (opz. 170)  
Natural Oak (opt. 170)

**ANTE VETRO  
GLASS DOORS**



Vetro antico (opz. V15)  
Antique-effect Glass (opt. V15)



Vetro Gotik (opz. V20)  
Gothic Glass (opt. V20)



Vetro Master Carrè (opz. V25)  
Master Carrè Glass (opt. V25)



Anta Rebecca  
 Rovere Naturale (opz. 170)  
 Maniglia Old Style (opz. B018)  
 Rebecca Door  
 Natural Oak (opt. 170)  
 Old Style handle (opt. B018)



Anta Vetro Master Carrè (opz. V25)  
 Door with Master Carrè Glass (opt. V25)



Top Serie Sassi  
 sp. 6 cm Travertino Chiaro (opz. 127)  
 Sassi Series Top  
 6 cm thick, Light Travertine (opt. 127)



Lavello in marmo ad incasso  
 colore Travertino Paglierino  
 (opz. M006)  
 Marble inset sink in Straw-coloured  
 Travertine (opt. M006)



Cornice cappello  
 colore Rovere Naturale (opz. 170) tipo B  
 Top Cornice  
 Natural Oak colour (opt. 170) type B



Muratura Panna a rullo (opz. R012)  
 Zoccolo  
 colore Rovere Naturale (opz. 170)  
 Roller Cream Masonry (opt. R012)  
 Plinth  
 Natural Oak Colour (opt. 170)







170 ~ REBECCA

**CARATTERISTICHE TECNICHE****Anta con bugna**

Telaio in massello e pannello impiallacciato in castagno, anticato e spazzolato Tinto Noce (opz. 135), Castagno Mielato (opz. 136) Bianco Antico (opz. 137), Verde Antico (opz.138) Castagno Gessato (opz. 139) spessore 32 mm

**Anta vetro**

Telaio in massello di castagno, anticato e spazzolato con i seguenti vetri:

- **di serie:** Vetro Anticato spessore 4 mm (opz. V15);
- **a richiesta:** Vetro Gotik spessore 4 mm (opz. V20).

**Struttura pensili**

In listellare impiallacciato sp. 25 mm colore come anta (opz. 090);

**Struttura cappe**

Fascione in frassino spazzolato, camino in multistrato di pioppo finitura effetto muro (vedi colori effetto muro pag. 36);

**Struttura basi e colonne**

Frontale e parti a vista in multistrato di pioppo finitura effetto muro (vedi colori effetto muro pag. 36):  
Cassone in listellare laminato oak, spessore 18 mm (opz. 110), o in listellare laminato twist, spessore 18 mm (opz. 115).

**Struttura cassette e cestoni**

In massello di faggio naturale con guide estrazione totale sistema blumotion.

**Mensole**

In listellare impiallacciato di castagno, finitura come anta.

**Zoccolo**

Impiallacciato frassino colore come anta h 10 cm

**TECHNICAL FEATURES****Door with raised panel**

Solid frame and veneer panel in chestnut, Walnut Stain brushed antique effect (opt. 135), Honey Chestnut (opt. 136) Antique White (opt. 137), Antique Green (opt. 138) Pinstripe Chestnut (opt. 139), thickness: 32 mm

**Glass door**

Frame in solid chestnut, brushed antique effect, with the following glass:

- **standard:** Antique-effect glass, 4 mm thick (opt. V15);
- **on request:** Gothic glass, 4 mm thick (opt. V20).

**Wall unit structure**

In veneered blockboard, 25 mm thick, same colour as doors (opt. 090);

**Hood structure**

Band in brushed ash, chimney in poplar plywood with wall-effect finish (see wall-effect colours on page 36);

**Columns and base unit structures**

Front panel and visible parts in poplar plywood with wall-effect finish (see wall-effect colours on page 36):

Carcass in blockboard with oak veneer, thickness: 18 mm (opt. 110) or in blockboard with twist veneer, thickness: 18 mm (opt. 115).

**Structures for drawers and deep drawers**

In solid natural beech with full extraction runners with blumotion system.

**Shelves**

In blockboard with chestnut veneer, same finish as doors.

**Plinth**

Ash veneer, same colour as doors h 10 cm



**ANTE  
DOORS**



Tinto Noce Antico (opz. 135)  
Antique Walnut Stain (opt. 135)



Mielato (opz. 136)  
Honey (opt. 136)



Bianco Antico (opz. 137)  
Antique White (opt. 137)



Verde Antico (opz. 138)  
Antique Green (opt. 138)

**ANTA GRATA LEGNO  
DOOR WITH GRATING WOOD**



Gessato (opz. 139)  
Pinstripe (opt. 139)



Mielato (opz. 136)  
Honey (opt. 136)

**ANTE VETRO  
GLASS DOORS**



Vetro Anticato (opz. V15)  
Antique-effect Glass (opt. V15)



Vetro Gotik (opz. V20)  
Gothic Glass (opt. V20)

130 ~ ANITA





Anta Bianco Antico (opz. 137)  
Pomo Terra Cotta (opz. B010)  
Antique White Door (opt. 137)  
Terracotta Knob (opt. B010)



Anta Vetro Gotik (opz. V20)  
Gothic Glass Door (opt. V20)



Top serie Vintage colore Ecrù (opz. 272)  
bordo massello sp. 6 cm  
Vintage Series Top, Ecrù colour  
(opt. 272) solid wood edge, 6 cm thick



Cornice cappello  
colore Bianco Antico (opz. 137) tipo A  
Top cornice  
Antique White colour (opt. 137) type A



Muratura Cuoio a rullo (opz. R260)  
Zoccolo  
colore Bianco Antico (opz. 137)  
Roller Leather masonry (opt. R260)  
Plinth Antique White colour (opt. 137)







130 ~ ANITA

MODELLI  
MODELS

**CARATTERISTICHE TECNICHE****Anta con pannello a rilievo**

Telaio in massello di frassino spazzolato, con anticature, maniglia ricavata nella parte superiore o inferiore del telaio e pannello centrale in rilievo con doghe verticali nei colori: Bianco Shabby (opz. 150), Noce (opz. 151), Elena Sabbia (opz. 156), spessore 24 mm

**Anta vetro**

Telaio in massello di frassino spazzolato anticato con inglesina, con vetro anticato spessore 4 mm (opz. V15).

**Struttura pensili**

In listellare impiallacciato frassino sp. 25 mm colore come anta.

**Struttura cappe**

Fascione in massello di frassino colore abbinato all'anta, camino in multistrato di pioppo finitura effetto muro (vedi colori effetto muro pag. 36).

**Struttura basi e colonne**

Frontale e parti a vista in multistrato di pioppo finitura effetto muro (vedi colori effetto muro pag. 36). Cassone in listellare laminato oak, spessore 18 mm (opz. 110), o in listellare laminato twist, spessore 18 mm (opz. 115).

**Struttura cassetti e cestoni**

In massello di faggio naturale con guide estrazione totale sistema blumotion.

**Mensole**

In listellare impiallacciato di frassino, finitura come anta.

**Zoccolo**

In multistrato impiallacciato frassino, colore come anta h 10 cm

**TECHNICAL FEATURES****Door with relief panel**

Frame in brushed solid ash, with antique effect, handle placed on the upper or lower part of the frame and central panel in relief with vertical slats in the following colours: Shabby white (opt. 150), Walnut (opt. 151), Elena Sand (opt. 156), thickness: 24 mm

**Glass door**

Frame in brushed solid ash with antique effect, with mullion accents, with antique-effect glass, thickness: 4 mm (opt. V15).

**Wall unit structure**

In ash veneered blockboard, 25 mm thick, same colour as doors.

**Hood structure**

Band in solid ash in the same colour as the doors, chimney in poplar plywood with wall-effect finish (see wall-effect colours on page 36);

**Columns and base unit structures**

Front panel and visible parts in poplar plywood with wall-effect finish (see wall-effect colours on page 36).

Carcass in blockboard with oak veneer, thickness: 18 mm (opt. 110) or in blockboard with twist veneer, thickness: 18 mm (opt. 115).

**Structures for drawers and deep drawers**

In solid natural beech with full extraction runners with blumotion system.

**Shelves**

In blockboard with ash veneer, same finish as doors.

**Plinth**

In plywood with ash veneer, same colour as doors h 10 cm

**ANTE  
DOORS**



Bianco Shabby (opz. 150)  
Shabby White (opt. 150)



Noce (opz. 151)  
Walnut (opt. 151)



Sabbia (opz. 156)  
Sand (opt. 156)

**ANTA VETRO  
GLASS DOORS**



Vetro anticato (opz. V15)  
Antique-effect Glass (opt. V15)

140 ~ ELENA





Anta Elena Sabbia (opz. 156)  
con presa maniglia su anta  
Elena Door in Sand (opt. 156) with  
handle grip on door



Anta vetro: Inglesina (opz. V15)  
Glass Door: Mullion accents (opt. V15)



Top Serie Sassi sp. 6 cm profilo G,  
colore Travertino Chiaro con inserti  
Travertino Noce (opz. 003)  
Sassi Series Top, 6 cm thick, profile  
G, Light Travertine colour with in-  
serts in Walnut Travertine (opt. 003)



Lavello ad incasso, in marmo  
colore Travertino Noce (opz. M004)  
Recessed sink, in Walnut Travertine  
coloured marble (opt. M004)



Cornice cappello tipo A  
colore Elena Sabbia (opz. 156)  
Top cornice type A  
colour Elena Sand (opt. 156)



Muratura Panna a rullo (opz. R012)  
Zoccolo  
colore Elena Sabbia (opz. 156)  
Roller Cream masonry (opt. R012)  
Plinth  
Elena Sand colour (opt. 156)







140 ~ ELENA

**CARATTERISTICHE TECNICHE****Anta con pannello fresato**

Telaio in massello di frassino con tagli a 45° e pannello a doghe orizzontali, nei colori: Noce Antico (opz. 161), Bianco Rustico (opz. 162), Gessato (opz. 163), Creta (opz. 164), anta spazzolata, tinta e patinata con effetto anticatura spessore 24 mm.

**Anta vetro**

Telaio in massello di frassino spazzolato e anticato con i seguenti vetri:

- **di serie:** Vetro Anticato spessore 4 mm (opz. V15);
- **a richiesta:** Vetro Gotik spessore 4 mm (opz. V20).

**Struttura pensili**

In listellare impiallacciato di frassino sp. 25 mm colore come anta.

**Struttura cappe**

Fascione in massello di frassino colore abbinato all'anta, camino in multistrato di pioppo finitura effetto muro (vedi colori effetto muro pag. 36).

**Struttura basi e colonne**

Frontale e parti a vista in multistrato di pioppo finitura effetto muro (vedi colori effetto muro pag. 36).

Cassone in listellare laminato oak, spessore 18 mm (opz. 110); o in listellare laminato twist, spessore 18 mm (opz. 115).

**Struttura cassette e cestoni**

In massello di faggio naturale con guide estrazione totale sistema blumotion.

**Mensole**

In listellare impiallacciato di frassino, finitura come anta.

**Zoccolo**

In multistrato impiallacciato frassino, colore come anta h 10 cm

**TECHNICAL FEATURES****Door with milled panel**

Frame in solid ash with 45° cuts and panel with horizontal slats, in the following colours: Antique Walnut (opt. 161), Rustic White (opt. 162), Pinstripe (opt. 163), Clay (opt. 164), brushed, stained and patinated door with antique effect, thickness: 24 mm.

**Glass door**

Frame in solid ash, brushed antique effect, with the following glass:

- **standard:** Antique-effect glass, 4 mm thick (opt. V15);
- **on request:** Gothic glass, 4 mm thick (opt. V20).

**Wall unit structure**

In ash veneered blockboard, 25 mm thick, same colour as doors.

**Hood structure**

Band in solid ash in the same colour as the doors, chimney in poplar plywood with wall-effect finish (see wall-effect colours on page 36);

**Columns and base unit structures**

Front panel and visible parts in poplar plywood with wall-effect finish (see wall-effect colours on page 36).

Carcass in blockboard with oak veneer, thickness: 18 mm (opt. 110) or in blockboard with twist veneer, thickness: 18 mm (opt. 115).

**Structures for drawers and deep drawers**

In solid natural beech with full extraction runners with blumotion system.

**Shelves**

In blockboard with ash veneer, same finish as doors.

**Plinth**

In plywood with ash veneer, same colour as doors h 10 cm



**ANTE  
DOORS**



Noce Antico (opz. 161)  
Antique Walnut (opt. 161)



Bianco Rustico (opz. 162)  
Rustic White (opt. 162)



Gessato (opz. 163)  
Pinstripe (opt. 163)



Creta (opz. 164)  
Clay (opt. 164)

**ANTA GRATA LEGNO  
DOOR WITH GRATING WOOD**



Noce Antico (opz. 161)  
Antique Walnut (opt. 161)

**ANTE VETRO  
GLASS DOORS**



Vetro Anticato (opz. V15)  
Antique-effect Glass (opt. V15)



Vetro Gotik (opz. V20)  
Gothic Glass (opt. V20)

160 ~ LUISA



Anta Luisa Gessata (opz. 163)  
 Maniglia ceramica  
 con pomo rosa (opz. B009)  
 Pinstripe Luisa Door (opt. 163)  
 Ceramic handle with pink knob  
 (opt. B009)



Anta Vetro Anticato (opz. V15)  
 Door with Antique-effect Glass  
 (opt. V15)



Top Serie Sassi sp. 5 cm  
 con torello colore Scabas Rosa (opz.110)  
 Sassi series top, 5 cm thick, with  
 Scabas Pink bullnose tile (opt.110)



Lavello in marmo ad incasso  
 colore Travertino Paglierino  
 (opz. M006)  
 Marble inset sink in Straw-coloured  
 Travertine (opt. M006)



Top in massello spessore 6 cm. profilo  
 L2 con Greca incassata,  
 spessore h. 3 cm (serie infinito)  
 Top in solid wood, 6 cm thick,  
 profile L2 with recessed fretwork  
 h. 3 cm (infinito series)



Cornice cappello tipo A  
 Luisa Gessata (opz. 163)  
 Top cornice type A  
 Pinstripe Luisa (opt. 163)



Muratura Bianco frattonato (F006)  
 Zoccolo colore  
 Luisa Gessata (opz. 163)  
 Trowel White masonry (F006)  
 Plinth colour  
 Pinstripe Luisa (opt. 163)







# 160 ~ LUISA



**CARATTERISTICHE TECNICHE****Anta con bugna**

Telaio e bugna in massello di frassino laccati colore Avorio con Sfumature Arancio (opz. 002), con Sfumature Giallo (opz. 003), laccato Bianco con Sfumature Grigie (opz. 007). L'effetto anticato è dato da un particolare processo di laccatura che lascia scoperte alcune parti dell'anta.

L'anta ha uno spessore di 24 mm;

**Anta vetro**

Telaio in frassino laccato con anticatura, spessore 24 mm, abbinabile ai seguenti vetri:

- **di serie:** Vetro Anticato spessore 4 mm (opz. V15)
- **a richiesta:** Vetro Gotik spessore 4 mm (opz. V20)

**Struttura pensili**

In listellare impiallacciato di frassino spessore 25 mm, colore come anta

**Struttura cappe**

Fascione in massello di frassino abbinato all'anta, camino in multistrato di pioppo finitura effetto muro (vedi muratura pag. 36).

**Struttura basi e colonne**

Frontale e parti a vista in multistrato di pioppo finitura effetto muro

(vedi colori effetto muro pag. 36)

Cassone in listellare laminato oak, spessore 18 mm (opz. 110), o listellare laminato twist, spessore 18 mm (opz. 115).

**Struttura cassette e cestoni**

In massello di faggio naturale con guide estrazione totale sistema blumotion.

**Mensole**

In listellare impiallacciato di frassino, finitura come anta.

**Zoccolo**

In multistrato impiallacciato, finitura come anta h 10 cm

**TECHNICAL FEATURES****Door with raised panel**

Frame and raised panel in solid ash in lacquered ash in Ivory with Orange highlights (opt. 002), with Yellow Highlights (opt. 003), White lacquer with Grey Highlights (opt. 007). The antique effect is created using a special lacquering process that leaves parts of the door uncoated.

The door is 24 mm thick;

**Glass door**

Frame in lacquered ash with antique effect, 24 mm thick, can be matched with the following glass:

- **standard:** Antique-effect glass, 4 mm thick (opt. V15)
- **on request:** Gothic glass, 4 mm thick (opt. V20)

**Wall unit structure**

In ash veneered blockboard, 25 mm thick, same colour as doors

**Hood structure**

Band in solid ash in the same colour as the doors, chimney in poplar plywood with wall-effect finish (see masonry on page 36);

**Columns and base unit structures**

Front panel and visible parts in poplar plywood with wall-effect finish (see wall-effect colours on page 36)

Carcass in blockboard with oak veneer, thickness: 18 mm (opt. 110) or in blockboard with twist veneer, thickness: 18 mm (opt. 115)

**Structures for drawers and deep drawers**

In solid natural beech with full extraction runners with blumotion system.

**Shelves**

In blockboard with ash veneer, same finish as doors.

**Plinth**

In plywood with veneer, same finish as doors h 10 cm

**ANTE  
DOORS**



Laccato Avorio Sfum. Arancio (opz. 002)  
Ivory Lacquer Orange Highlights (opt. 002)



Laccato Avorio Sfum. Giallo (opz. 003)  
Ivory Lacquer Yellow Highlights (opt. 003)

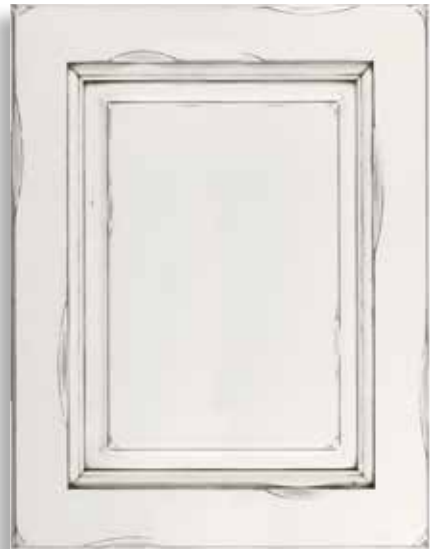

Laccato Bianco Sfum. Grigie (opz. 007)  
White Lacquer Grey Highlights (opt. 007)

**ANTA GRATA LEGNO  
DOOR WITH GRATING WOOD**



Laccato Avorio Sfum. Giallo (opz. 003)  
Ivory Lacquer Yellow Highlights (opt. 003)

**ANTE VETRO  
GLASS DOORS**



Vetro Anticato (opz. V15)  
Antique-effect Glass (opt. V15)



Vetro Gotik (opz. V20)  
Gothic Glass (opt. V20)



Anta Onelia Laccata Avorio  
Sfumatura Arancio (opz. 002)  
Maniglia ottone (opz.183)  
Onelia Door in Ivory Lacquer with  
Orange Highlights (opt. 002)  
Brass handle (opt. 183)



Anta Vetro Anticato (opz. V15)  
Door with Antique-effect Glass  
(opt. V15)



Top Serie Cotto colore Avorio  
sp. 4 cm (opz. 260)  
Cotto Series Top in Ivory, 4 cm thick  
(opt. 260)



Cornice cappello Laccato Avorio  
Sfumatura Arancio (opz. 002)  
Top cornice in Ivory Lacquer with  
Orange Highlights (opt. 002)



Muratura Corda frattonato (opz. F125)  
Zoccolo colore Laccato Avorio  
Sfumatura Arancio (opz. 002)  
Trowel Jute masonry (opt. F125)  
Plinth in Ivory Lacquer with Orange  
Highlights (opt. 002)







111 ~ ONELIA LACCATA

**CARATTERISTICHE TECNICHE****Anta con bugna**

Telaio e bugna in massello di frassino tinto Noce  
Anticato a straccio (opz. 110)  
Spessore 24 mm

**Anta vetro**

Telaio in frassino tinto Noce Anticato a straccio  
(opz. 110)  
Spessore 24 mm con i seguenti vetri:  
• **di serie:** Vetro Anticato spessore 4 mm (opz. V15);  
• **a richiesta:** Vetro Gotik spessore 4 mm (opz. V20).

**Struttura pensili**

In listellare impiallacciato di frassino,  
spessore 25 mm colore come ante.

**Struttura cappe**

Fascione in massello di frassino tinto noce,  
camino in multistrato di pioppo finitura  
effetto muro (vedi colori effetto muro pag. 36)

**Struttura basi e colonne**

Frontale e parti a vista in multistrato di pioppo  
finitura effetto muro (vedi colori effetto muro pag. 36)  
Cassone in listellare laminato oak  
spessore 18 mm (opz. 110)

**Struttura cassette e cestoni**

In massello di faggio naturale con guide estrazione  
totale sistema blumotion.

**Mensole**

In listellare impiallacciato di frassino,  
finitura come anta

**Zoccolo**

In multistrato impiallacciato,  
finitura come anta h 10 cm

**TECHNICAL FEATURES****Door with raised panel**

Frame and raised panel in solid ash in worn  
Antique Walnut stain (opt. 110)  
Thickness 24 mm

**Glass door**

Frame in ash in worn Antique Walnut stain (opt. 110)  
24 mm thick, with the following glass:  
• **standard:** Antique-effect glass, 4 mm thick (opt. V15);  
• **on request:** Gothic glass, 4 mm thick (opt. V20).

**Wall unit structure**

In blockboard with ash veneer, 25 mm thick,  
same finish as doors.

**Hood structure**

Band in solid ash in ash with walnut stain,  
chimney in poplar plywood with wall-effect finish  
(see wall-effect colours on page 36);

**Columns and base unit structures**

Front panel and visible parts in poplar plywood  
with wall-effect finish (see wall-effect colours  
on page 36)  
Carcass in blockboard with oak veneer,  
18 mm thick (opt. 110)

**Structures for drawers and deep drawers**

In solid natural beech with full extraction runners  
with blumotion system.

**Shelves**

In blockboard with ash veneer,  
same finish as doors

**Plinth**

In plywood with veneer,  
same finish as doors h 10 cm



**ANTE  
DOORS**



Frassino Tinto Noce (opz. 110)  
Walnut Stained Ash (opt. 110)

**ANTA GRATA LEGNO  
DOOR WITH GRATING WOOD**



Frassino Tinto Noce (opz. 110)  
Walnut Stained Ash (opt. 110)

**ANTE VETRO  
GLASS DOORS**



Vetro Anticato (opz. V15)  
Antique-effect Glass (opt. V15)



Vetro Gotik (opz. V20)  
Gothic Glass (opt. V20)

110 ~ ONELIA NOCE



Anta Onelia Noce (opz. 110)  
 Maniglia conchiglia bronzo (opz. 180)  
 Onelia Door in Walnut (opt. 110)  
 Shell Handle bronze (opt. 180)



Anta Vetro: Anticato (opz V15)  
 Glass door: Antique finish (opt. V15)



Top Serie Sassi  
 sp. 4 cm colore Travertino Chiaro  
 (opz. 127)  
 Sassi Series Top  
 4 cm thick, in Light Travertine  
 (opt. 127)



Cornice cappello tipo A  
 colore Onelia Noce (opz. 110)  
 Top cornice type A  
 Onelia Walnut colour (opt. 110)



Muratura Panna frattonato (opz. F012)  
 Zoccolo  
 colore Onelia Noce (opz. 110)  
 Trowel Cream masonry  
 (opt. F012)  
 Plinth  
 Onelia Walnut colour (opt. 110)







110 ~ ONELIA NOCE

**CARATTERISTICHE TECNICHE****Anta con bugna**

Telaio e bugna in pioppo, nelle finiture colori: Laccato Bianco Antico Sfumature Oro (opz. 140), Laccato Giallo Grano (opz. 147), Laccato Verde Salvia (opz. 146), Laccato Argilla con Sfumature Avorio (opz. 148) Tinto Noce Antico (opz. 145). L'effetto anticato è dato da un particolare processo di laccatura che lascia scoperte alcune parti dell'anta.

**Anta vetro**

Telaio in massello di pioppo, spessore 24 mm. Abbinabile ai seguenti vetri:

- **di serie:** Vetro Anticato spessore 4 mm (opz. V15);
- **a richiesta:** Vetro Gotik spessore 4 mm (opz. V20).

**Struttura pensili**

In listellare impiallacciato diiglio sp. 25 mm colore come anta.

**Struttura cappe**

Fascione in massello diiglio colore come anta, camino in multistrato di pioppo finitura effetto muro (vedi colori effetto muro pag. 36);

**Struttura basi e colonne**

Frontale e parti a vista in multistrato di pioppo finitura effetto muro (vedi colori effetto muro pag. 36). Cassone in listellare laminato oak, spessore 18 mm (opz. 110), o in listellare laminato twist, spessore 18 mm (opz. 115);

**Struttura cassette e cestoni**

Interno in massello di faggio naturale con guide estrazione totale sistema blumotion.

**Mensole**

In listellare impiallacciato diiglio, finitura come anta.

**Zoccolo**

In multistrato impiallacciato diiglio, finitura come anta h 10 cm.

**TECHNICAL FEATURES****Door with raised panel**

Frame and raised panel in poplar, in the following colours: Antique White Lacquer with Gold Highlights (opt. 140), Corn Yellow Lacquer (opt. 147), Sage Green Lacquer (opt. 146), Clay Lacquer with Ivory Highlights (opt. 148) Antique Walnut Stain (opt. 145). The antique effect is created using a special lacquering process that leaves parts of the door uncoated.

**Glass door**

Frame in solid poplar, 24 mm thick. Can be matched with the following glass:

- **standard:** Antique-effect glass, 4 mm thick (opt. V15);
- **on request:** Gothic glass, 4 mm thick (opt. V20).

**Wall unit structure**

In lime veneered blockboard, 25 mm thick, same colour as doors.

**Hood structure**

Band in solid lime in the same colour as the doors, chimney in poplar plywood with wall-effect finish (see wall-effect colours on page 36);

**Columns and base unit structures**

Front panel and visible parts in poplar plywood with wall-effect finish (see wall-effect colours on page 36). Carcass in blockboard with oak veneer, thickness: 18 mm (opt. 110) or in blockboard with twist veneer, thickness: 18 mm (opt. 115);

**Structures for drawers and deep drawers**

Interior in solid natural beech with full extraction runners with blumotion system.

**Shelves**

In blockboard with lime veneer, same finish as doors.

**Plinth**

In plywood with lime veneer, same finish as doors h 10 cm.



**ANTE  
DOORS**



Laccato Bianco Sfumatura Oro (opz.140)  
White Lacquer Gold Highlights (opt.140)



Verde Salvia (opz.146)  
Sage Green (opt. 146)



Giallo Grano (opz.147)  
Corn Yellow (opt.147)



Argilla Sfumatura Avorio (opz.148)  
Clay Ivory Highlights (opt.148)

**ANTA GRATA LEGNO  
DOOR WITH GRATING WOOD**



Noce Antico (opz 145)  
Antique Walnut (opt. 145)



Noce Antico (opz 145)  
Antique Walnut (opt. 145)

**ANTE VETRO  
GLASS DOORS**



Vetro Antico (opz. V45)  
Antique Glass (opt. V45)



Vetro Gotik (opz. V20)  
Gothic Glass (opt. V20)

135 ~ BEATRICE



Anta Legno e Pomello Terracotta  
Bianca con decoro bassorilievo  
(opz. B008)  
Wooden Door and white Terracotta  
Knob with bas-relief decoration  
(opt. B008)



Anta Vetro Gotik (opz. V20)  
Gothic Glass Door (opt. V20)



Top Serie Pietra colore Pietra di Nes  
(opz. 034), spessore 6 cm.  
Pietra Series Top in Nes Stone  
colour (opt. 034), 6 cm thick.



Lavello Botticino (opz. M001)  
Botticino Sink (opt. M001)



Top in massello sp. 6 cm, profilo L2  
con incasso spessore Greca 3 cm.  
(Serie Rosa)  
Top in solid wood, 6 cm thick, L2  
profile with recessed fretwork, 3 cm  
thick. (Rosa Series)



Cornice tipo A  
Frame type A



Muratura Panna (opz. R012)  
Zoccolo Beatrice Noce (opz. 145)  
Cream masonry (opt. R012)  
Beatrice plinth in Walnut (opt. 145)







135 ~ BEATRICE



Maniglia 183  
finitura ottone anticato passo mm 96  
Handle 183  
antique brass finish, 96 mm span



Maniglia 115  
finitura ottone anticato passo mm 96  
Handle 115  
antique brass finish, 96 mm span



Maniglia 605  
finitura argento anticato passo mm 96  
Handle 605  
antique silver finish, 96 mm span



Maniglia B022  
finitura nichel satinato passo mm 160  
Handle B022  
satin nickel finish, 160 mm span



Maniglia 193  
finitura ottone anticato  
Handle 193  
antique brass finish



Maniglia 140  
finitura ottone anticato passo mm 96  
Handle 140  
antique brass finish, 96 mm span



Maniglia 218  
finitura nichel passo mm 128  
Handle 218  
nickel finish, 128 mm span



Maniglia 232  
finitura nichel satinato  
anta L 15 → pomo  
da L 30 a L 90 → passo 160 mm.  
Handle 232  
satin nickel finish door W 15 → knob  
from W 30 to W 90 → span 160 mm.



Pomo 190  
finitura ottone anticato passo mm 32  
Knob 190  
antique brass finish, 32 mm span



Maniglia 180  
finitura ottone anticato passo mm 64  
Handle 180  
antique brass finish, 64 mm span



Maniglia B020  
finitura argento anticato passo mm 160  
Handle B020  
antique silver finish, 160 mm span



Pomello 232P  
finitura nichel satinato  
Knob 232P  
satin nickel finish





Maniglia 226 - metallo finitura nero opaco  
 anta L 15 → pomo  
 anta da L 30 a L 40 → passo 96 mm  
 anta da L 45 a L 60 → passo 160 mm  
 Handle 226 - matt black metal finish door  
 W 15 → knob  
 door from W 30 to W 40 → span 96 mm  
 door from W 45 to W 60 → span 160 mm



Maniglia 230 - metallo finitura nichel satinato  
 anta L 15 → pomo  
 anta da L 30 a L 90 → passo 160 mm  
 Handle 230 - satin nickel finish metal  
 door W 15 → knob  
 door from W 30 to W 90 → span 160 mm



Maniglia 240 - metallo satinato vintage  
 anta da L 15 a L 30 → passo 64 mm  
 anta da L 40 a L 90 → passo 160 mm  
 Handle 240 - vintage satin finish metal  
 door from W 15 to L 30 → span 64 mm  
 door from W 40 to W 90 → span 160 mm



Maniglia 235 - in ferro finitura nero opaco  
 anta da L 15 a L 30 → passo 96 mm  
 anta da L 30 a L 90 → passo 160 mm  
 Handle 235 - iron in matt black finish  
 door from W 15 to W 30 → span 96 mm  
 door from W 30 to W 90 → span 160 mm



Maniglia 222 - metallo finitura piombo  
 anta L 15 → pomo 160 mm  
 anta da L 30 a L 90 → passo 96 mm  
 Handle 222 - lead finish metal  
 door W 15 → knob 160 mm  
 door from W 30 to W 90 → span 96 mm



Maniglia 220 - metallo finitura nero opaco  
 anta L 15 → pomo  
 anta da L 30 a L 90 → passo 128 mm  
 Handle 220 - metal in matt black finish  
 door W 15 → knob  
 door from W 30 to W 90 → span 128 mm



Maniglia 575 - finitura piombo vintage  
 anta da L 15 a L 40 → passo 64 mm  
 anta da L 45 a L 90 → passo 192 mm  
 Handle 575 - vintage lead finish  
 door from W 15 to W 40 → span 64 mm  
 door from W 45 to W 90 → span 192 mm



Maniglia 581 ad incasso - finitura bronzo-titanio  
 anta da L 15 a L 30 → passo 67 mm  
 anta da L 30 a L 90 → passo 126 mm  
 Recessed handle 581 - bronze-titanium finish  
 door from W 15 to W 30 → span 67 mm  
 door from W 30 to W 90 → span 126 mm



Maniglia 224 - metallo finitura rame  
 anta L 15 → pomo 160 mm  
 anta da L 30 a L 90 → passo 96 mm  
 Handle 224 - copper finish metal  
 door W 15 → knob 160 mm  
 door from W 30 to W 90 → span 96 mm



Maniglia 228 - metallo finitura nero opaco  
 anta da L 15 a L 40 → passo 128 mm  
 anta da L 45 a L 90 → passo 160 mm  
 Handle 228 - metal in matt black finish  
 door from W 15 to L40 → span 128 mm  
 door from W 45 to W 90 → span 160 mm



Maniglia 248 - finitura bronzo scuro  
 passo 160 mm  
 Handle 248 - dark bronze finish  
 span 160 mm

# Maniglie vintage/ Vintage handles



Pomo B008  
Pomo in terra cotta bianca con decoro in bassorilievo  
Knob B008  
White terracotta knob with bas-relief decoration



Pomo B009  
Pomo in ceramica bianco opaco  
Knob B009  
Matt white ceramic knob



Pomo B016  
Pomo in terra cotta con decoro  
Knob B016  
Terracotta knob with decoration



Maniglia B005  
Maniglia in ferro verde ramato con decoro ceramica fatto a mano passo mm 96  
Handle B005  
Handle in green copper-coated iron with hand-made ceramic decoration, 96 mm span



Pomo B002  
Pomo in terra cotta nera con decoro  
Knob B002  
Black terracotta knob with decoration



Pomo B010  
Pomo in terra cotta con decoro in bassorilievo  
Knob B010  
Terracotta knob with bas-relief decoration



Pomo B014  
Pomo in terra cotta con decoro  
Knob B014  
Terracotta knob with decoration



Maniglia B006  
Maniglia in ferro con decoro ceramica fatto a mano passo mm 96  
Handle B006  
Handle in iron with hand-made ceramic decoration, 96 mm span



Pomo B030 - finitura argento anticato con intarsio in ceramica  
Misura 5 x 4,5 cm - passo mm 32  
Knob B030 - antique silver finish with ceramic inlay  
Measurements 5 x 4.5 cm - span 32 mm



Maniglia B040  
Maniglia in argento anticato con decoro  
passo mm 160  
Handle B040  
antique silver with decoration, 160 mm span



Pomo 611B  
Pomo in ottone con formella bianca  
Knob 611B  
Knob in brass with white tile



Maniglia old style  
in ferro battuto anticato  
B017 passo mm 96 -  
B018 passo mm 160 -  
Old style handle  
in antique wrought iron  
B017 96 mm span -  
B018 160 mm span -

Tutte le Maniglie e i Pomi "Artigianato Artistico" sono pezzi unici con lavorazioni e decori manuali. Gli articoli "Maniglie e Pomi" possono variare tra loro per la tipologia di lavorazione.

All "Artistic craft" handles are unique, with hand-crafted processing and decorations. "Handles and knobs" items may vary from one piece to another due to their processing.





---

## Maniglie artigianate artistico/ Artistic craft handles



**BIANCO**  
WHITE  
rullo (R006)      frattonato (F006)  
roller (R006)      trowel (F006)



**GIALLO CHIARO**  
LIGHT YELLOW  
rullo (R023)      frattonato (F023)  
roller (R023)      trowel (F023)



**PANNA**  
CREAM  
rullo (R012)      frattonato (F012)  
roller (R012)      trowel (F012)



**CIPRIA**  
PALE PINK  
rullo (R114)      frattonato (F114)  
roller (R114)      trowel (F114)



**GRIGIO TRAFFICO**  
TRAFFIC GREY  
rullo (R260)      frattonato (F260)  
roller (R260)      trowel (F260)



**PALE ASH**  
PALE ASH  
rullo (R114)      frattonato (F012)  
roller (R114)      trowel (F012)



**CORDA**  
JUTE  
rullo (R125)      frattonato (F125)  
roller (R125)      trowel (F125)



**GRIGIO PERLA**  
PEARL GREY  
rullo (R255)      frattonato (F255)  
roller (R255)      trowel (F255)

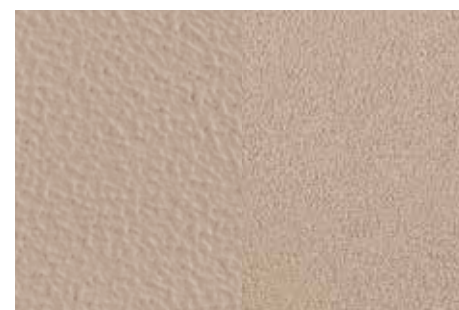

**CUOIO**  
LEATHER  
rullo (R250)      frattonato (F250)  
roller (R250)      trowel (F250)

**VERNICE RULLO**  
ROLLER PAINT

Cod. QVER1

**VERNICE FRATTONATA**  
TROWEL PAINT

Cod. QVER2

**CAMPIONI EFFETTO MURO**  
WALL-EFFECT SAMPLES

Cod QXCAMP

**FINITURE**

I frontali e le parti a vista effetto muro sono verniciate con materiali a base di quarzo ed altri elementi naturali.

Le superfici così ottenute sono antimacchia e antigraffio, lavabili con acqua e sapone neutro.

Evitare l'uso di solventi e/o alcool.

Macchie quali caffè e vino rosso possono creare, ove lasciate sedimentare, aloni non rimovibili.

N.B.: ogni composizione verrà corredata di kit manutenzione composto da barattolo di finitura effetto muro (gr. 400) e stucco bianco.

**FINISHES**

The front panels and visible parts with masonry effect are painted with quartz-based materials and other natural elements. The surfaces thus created are stain and scratch-resistant, they can be washed with water and neutral soap.

Avoid the use of solvents and/or alcohol. Stains such as coffee and red wine if left un-cleaned may create non-removable haloes.

N.B.: each composition will be provided with a maintenance kit comprised of a tub of wall-effect finish (400g) and white putty.





Colori effetto muro/ Wall-effect colours

MANIGLIE / STRUCTURE  
HANDLES / STRUCTURES

*Beatrice Salvia*



Vetro Antico 75 (opz. V15)  
Antique Glass 75 (opt. V15)

**n.b.: di serie in tutti i modelli**  
**n.b.: standard on all models**



Vetro Gotik (opz. V20)  
Gothic Glass (opt. V20)

**n.b.: a richiesta per tutti i modelli, escluso modello ELENA**  
**n.b.: on request for all models, except ELENA model**



Vetro Master Carrè (opz. V25)  
Master Carrè Glass (opt. V25)

**n.b.: esclusivo per modello REBECCA**  
**n.b.: exclusive to REBECCA model**



Cornice tipo A  
Frame type A

Cod. (QCOR1)

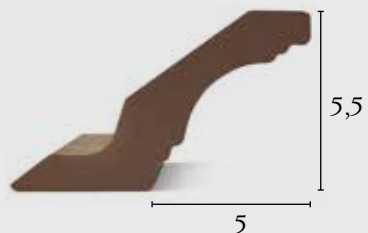

**DI SERIE IN TUTTI I MODELLI**  
**STANDARD ON ALL MODELS**



Cornice tipo B  
Frame type B

Cod. (QCOR2)

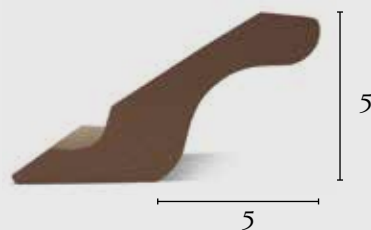

**A RICHIESTA**  
**ON REQUEST**



Cornice tipo C  
Frame type C

Cod. (QCOR3)

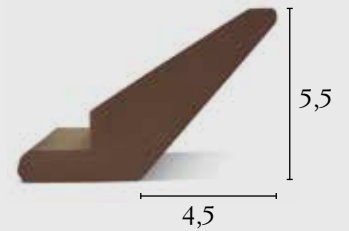

**A RICHIESTA**  
**ON REQUEST**



**SEZIONE PENSILE**  
**WALL UNIT CROSS SECTION**



**SEZIONE BASE**  
**BASE UNIT CROSS SECTION**



**BASI E CASSONI / BASE UNITS AND CARCASSES**

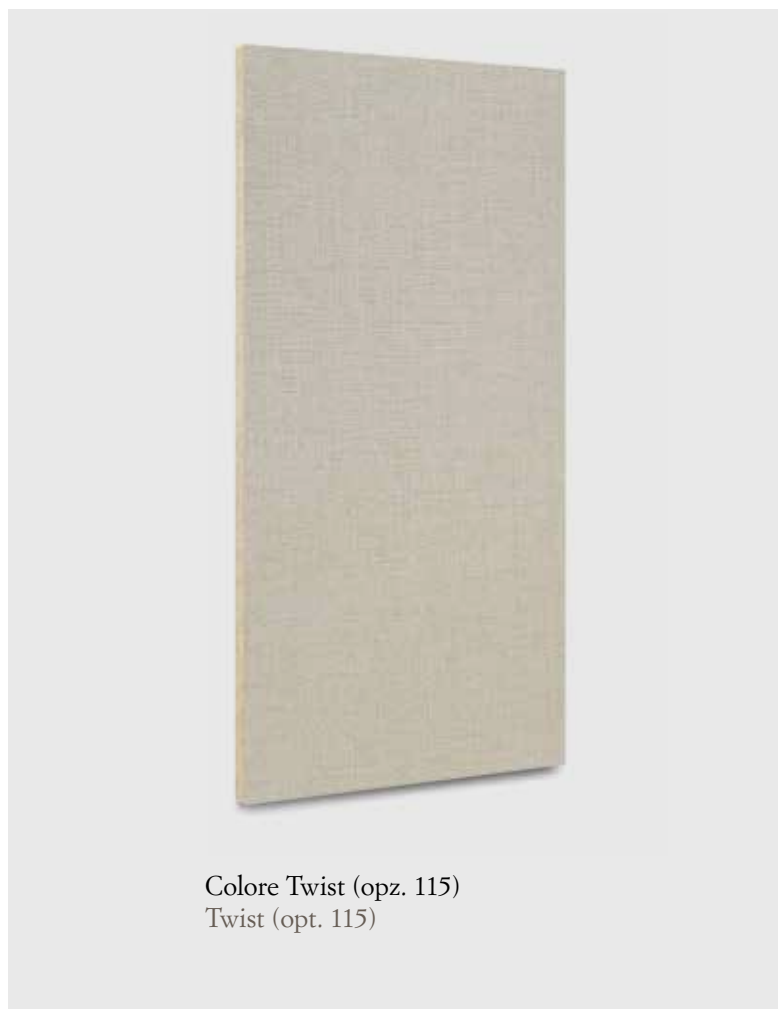

CERNIERE / HINGES



Cerniera brunita con finta anuba  
N.B.: solo per modello Anita  
Burnished hinge with false anuba  
N.B.: only for Anita model



Anuba Ottone Anticato  
Anuba Antique brass



Cerniera ammortizzata Blum  
N.B.: a richiesta esclusivo per modello Rebecca  
Amortised Blum hinge  
N.B.: on request, exclusive to Rebecca model



Anuba Argento Antico  
Anuba Antique Silver

Cerniera Anuba di serie per tutti i modelli escluso Anita, in abbinamento al colore della maniglia  
Anuba hinge as standard for all models except Anita, matching handle colour

ZOCCOLO / PLINTH

Cod. QZ1  
Zoccolo impiallacciato H 10 P 1,2 al ml  
Veneered plinth H 10 D 1.2 per lm



Cod. QZ10  
Giunzione lineare  
Linear joint



Cod. QZ90  
Giunzione 90°  
90° joint



Cod. QZ36  
Giunzione multiangolo  
Multi-angle joint  
0-360° ∪





TIPOLOGIE DI NICCHIE QUADRATE E ROTONDE  
 SQUARE AND ROUND NICHE TYPES

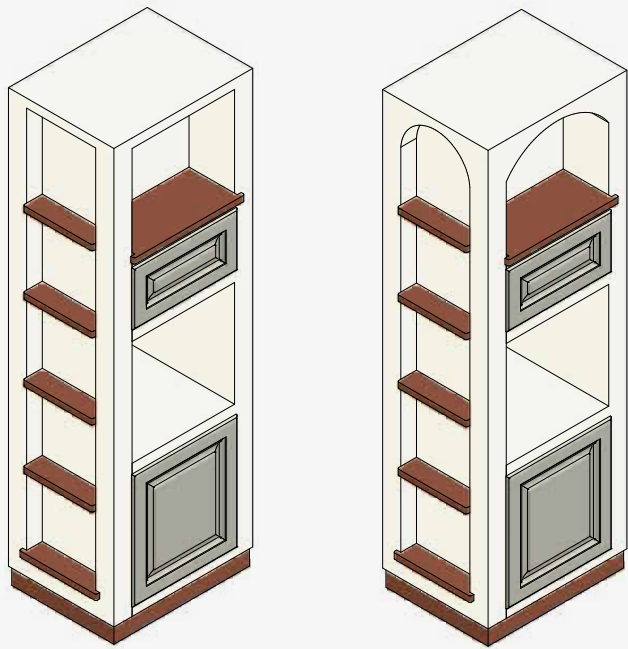

Colonna forno nicchia quadrata/rotonda  
 Oven column square/round niche

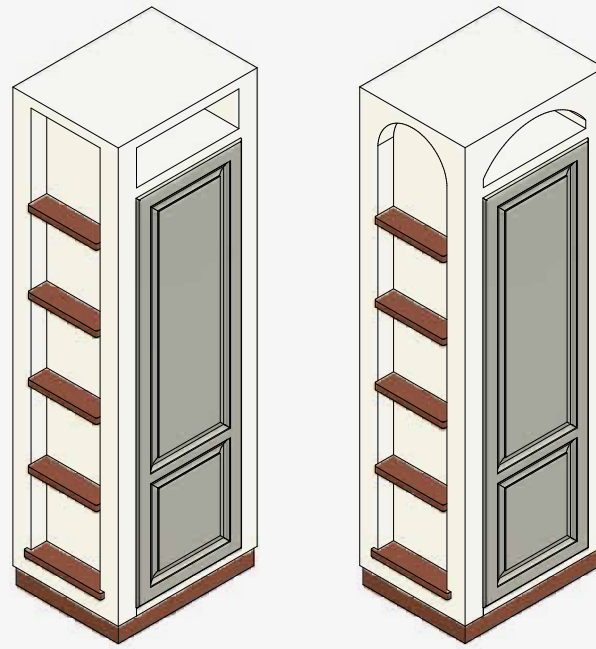

Colonna dispensa/frigo nicchia quadrata/rotonda  
 Cupboard/fridge column square/round niche

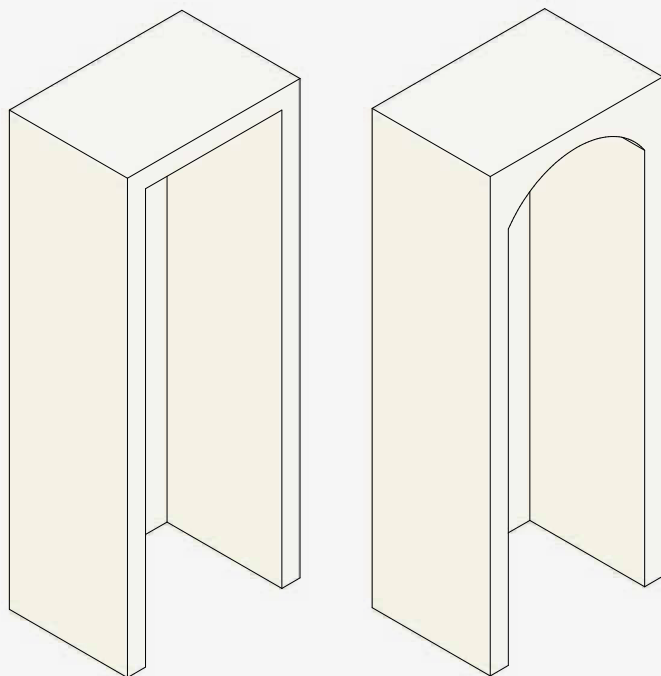

Colonna free standing nicchia quadrata/rotonda  
 Free-standing column square/round niche

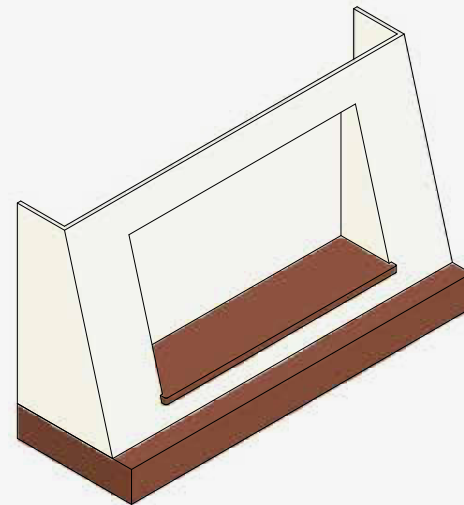

Cappa camino nicchia quadrata  
 Chimney hood square niche

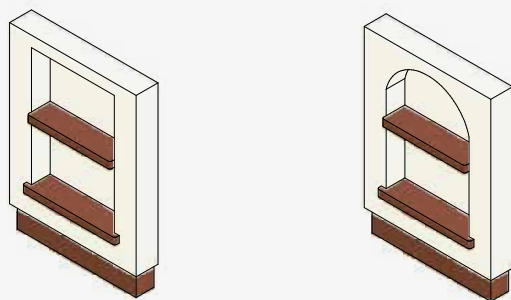

Fianco terminale con nicchia quadrata/rotonda  
 End side panel with square/round niche

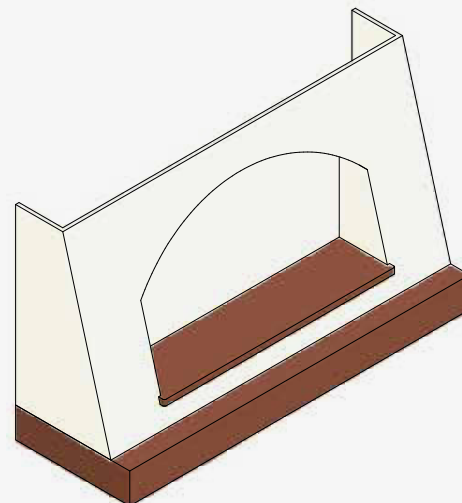

Cappa camino nicchia rotonda  
 Chimney hood round niche



*Onelia Bianca Sfumature Grigie*



## MODULO DI SERIE BLOCCO LIVING / LIVING ROOM BLOCK STANDARD MODULE

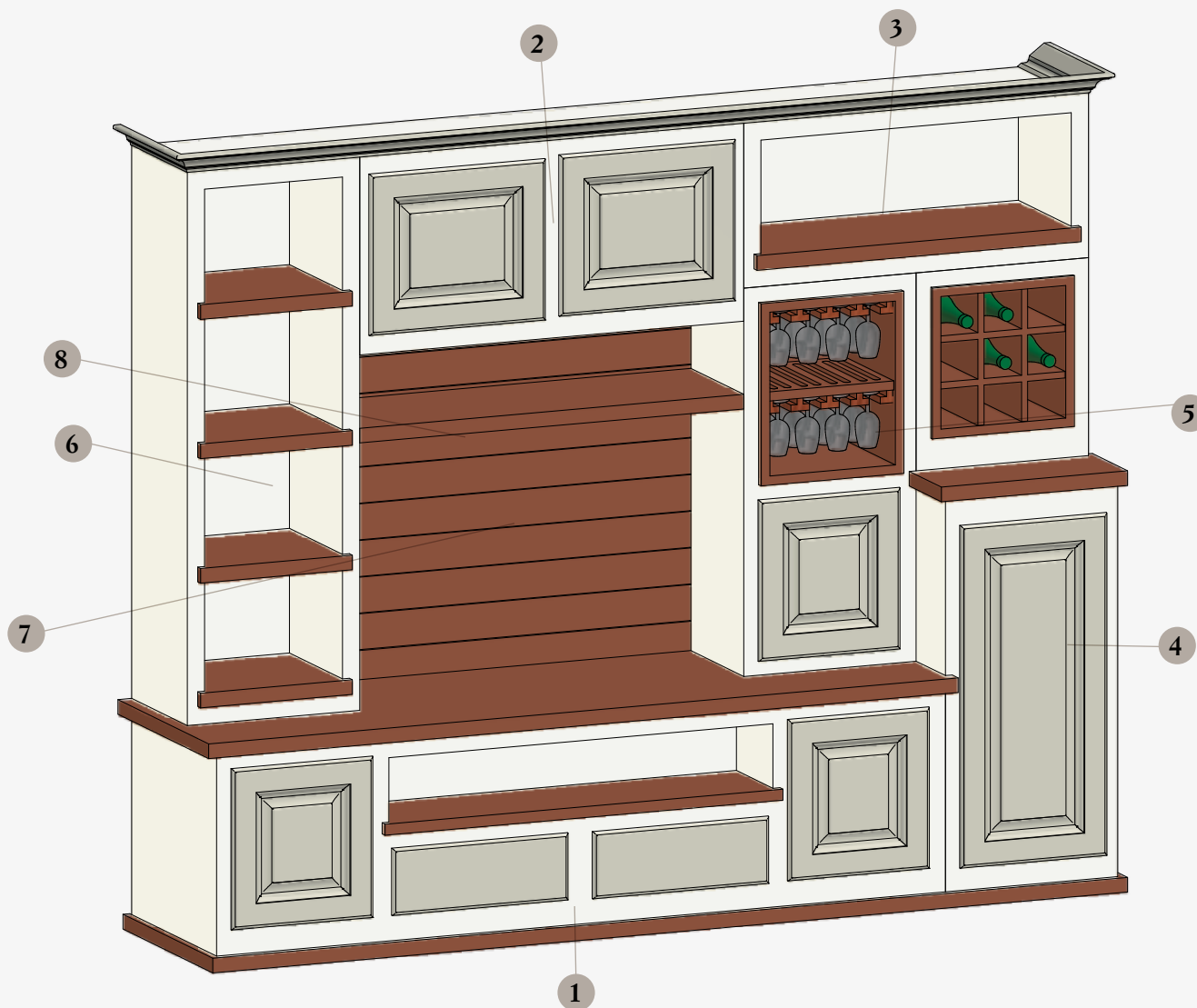

### Legenda / Key

- |  |  |   |
|--|--|---|
| 1. Basamento con 2 cassetti e 2 cestoni<br>Base 2 drawers and 2 deep drawers     | 4. Elemento colonna "D1" e portabottiglie 1 anta<br>Column element "D1" and bottle rack 1 door   | 7. Schienale impiallacciato a doghe<br>Back panel veneered with slats |
| 2. Elemento pensile effetto muro 2 ante<br>Wall unit element wall effect 2 doors | 5. Elemento colonna "E1" 1 anta con portabicchieri<br>Column element "E1" 1 door with glass rack | 8. Mensola impiallacciata<br>Veneered shelf                           |
| 3. Elemento "C1" nicchia con mensola<br>Element "C1" niche with shelf            | 6. Elemento colonna "F1" nicchia con 4 mensole<br>Column element "F1" niche with 4 shelves       |   |

### DESCRIZIONE DESCRIPTION

### CODICE CODE

Blocco living L 261,5 H 214 P 58  
con alloggio Tv, bicchieri, portabottiglie, cestoni estraibili,  
nicchie con mensole predisposte per faretto, parti in legno  
colori abbinato anta e struttura verniciata effetto muro  
Living room block W 261.5 H 214 D 58 with compartments  
for TV, glasses, bottle racks, removable deep drawers, niches  
with shelves configured for spotlights, parts in wood  
with doors and structure painted in wall-effect

L 261,5 QL001 DX  
L 261,5 QL002 SX







Living / Living room

*Rebecca Rovere Fango*

PENSOLE / LIVING  
PENINSULAS /  
LIVING ROOM

MODULO LIVING DI SERIE / STANDARD LIVING ROOM MODULE



**Legenda / Key**

- |   |  |   |
|---|--|---|
| 1. Base living, 1 cestone<br>Living room base unit, 1 deep drawer | 5. Mensola impiallacciata<br>Veneered shelf  | 9. Spalla impiallacciata sp. 2,5 H24/96/228<br>Veneered upright th 2.5 H24/96/228                       |
| 2. Basamento living<br>Living room base                           | 6. Top impiallacciato<br>Veneered top  | 10. Schienale impiallacciato sp. 2,8 doghe verticali<br>Back panel veneered th. 2.8 with vertical slats |
| 3. Anta ribalta per living<br>Drop-front door for living room     | 7. Elemento spalla impiallacciato sp. 2,5 H 96<br>Veneered upright element th 2.5 H 96 |   |
| 4. Pensile folding<br>Folding wall unit                           | 8. Elemento spalla impiallacciato sp. 2,5 H 24<br>Veneered upright element th 2.5 H 24 |   |



130 ~ ANITA Gessata







130 ~ ANITA Gessata



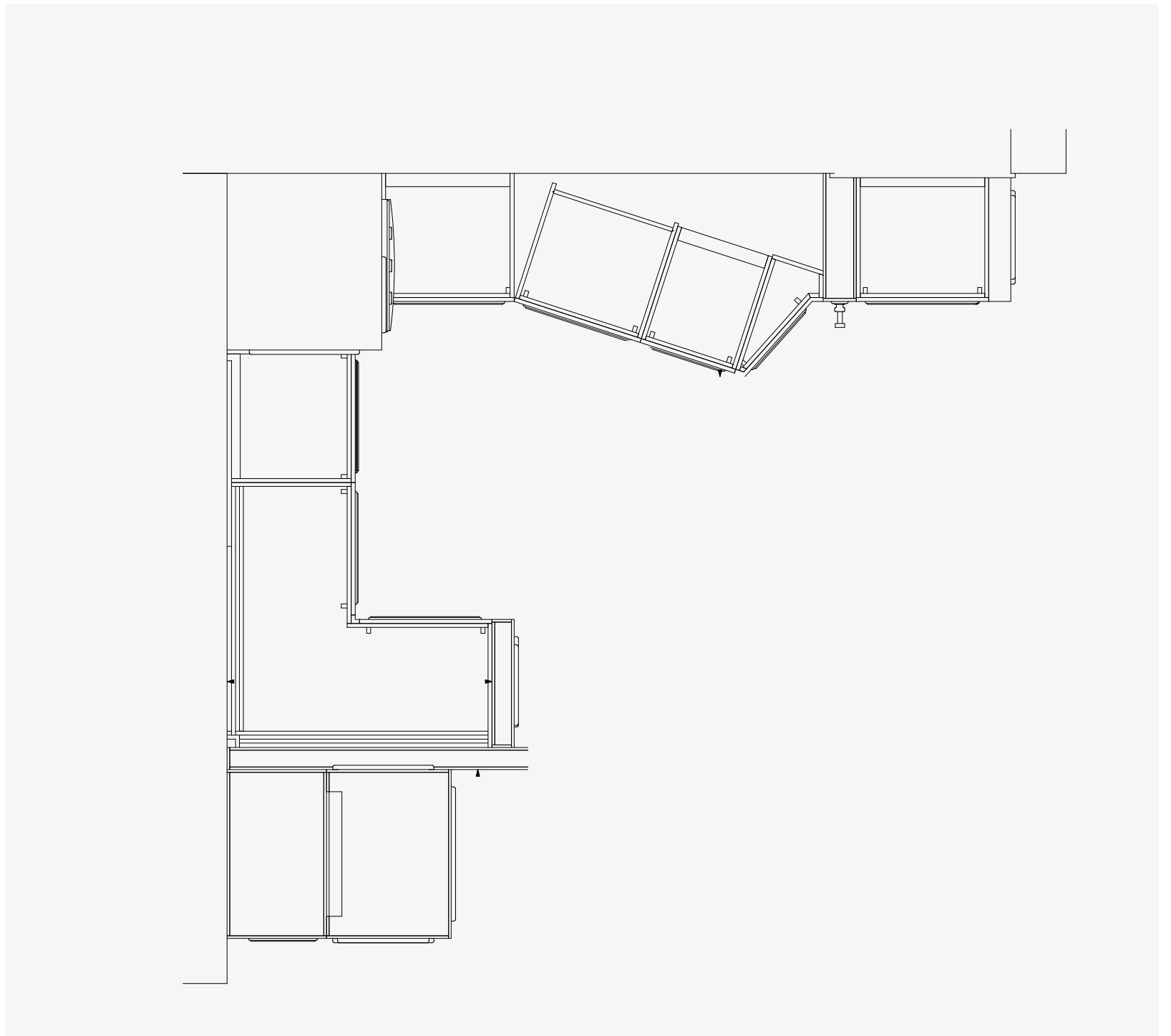

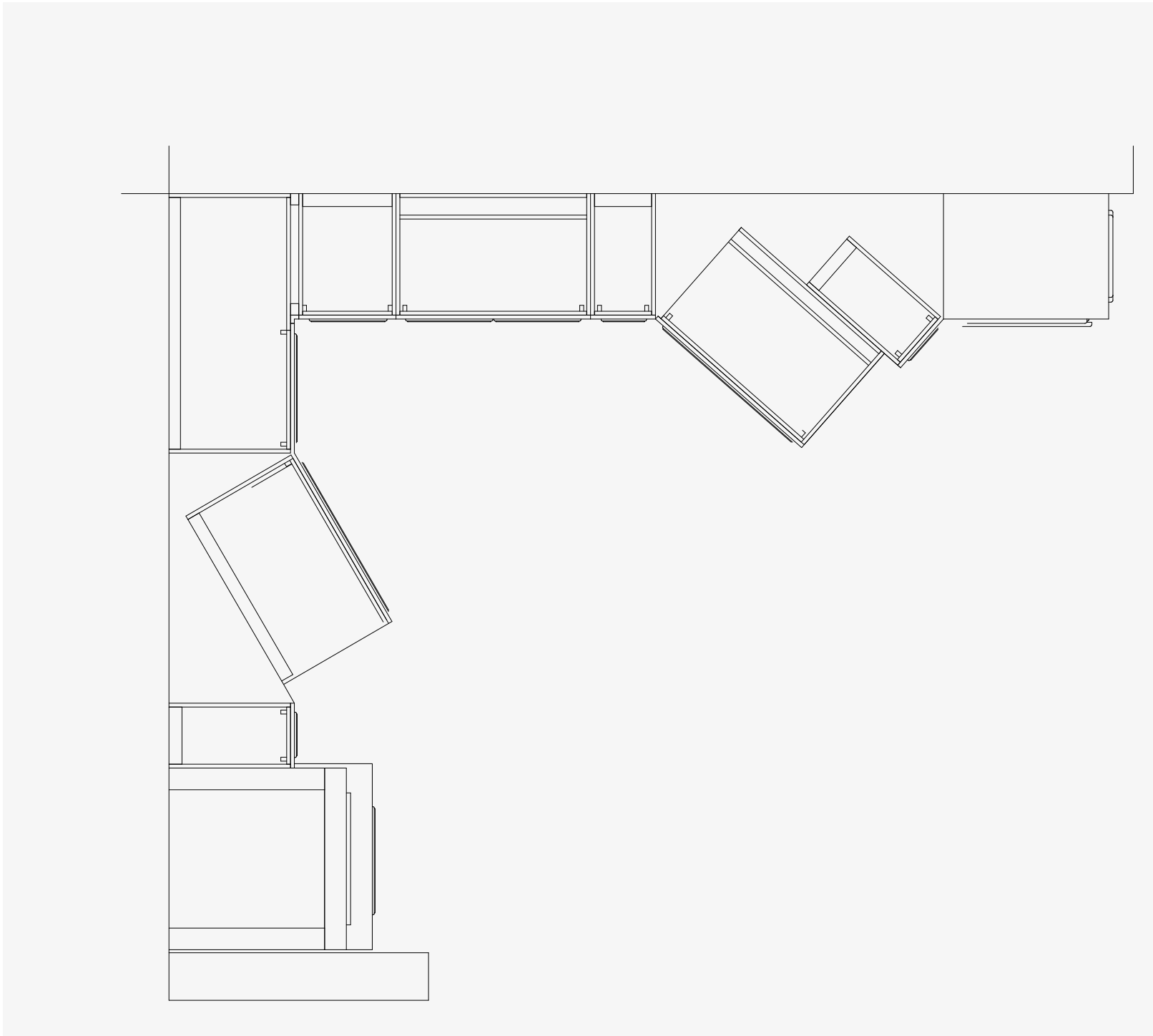

Composizione tipo / Composition type



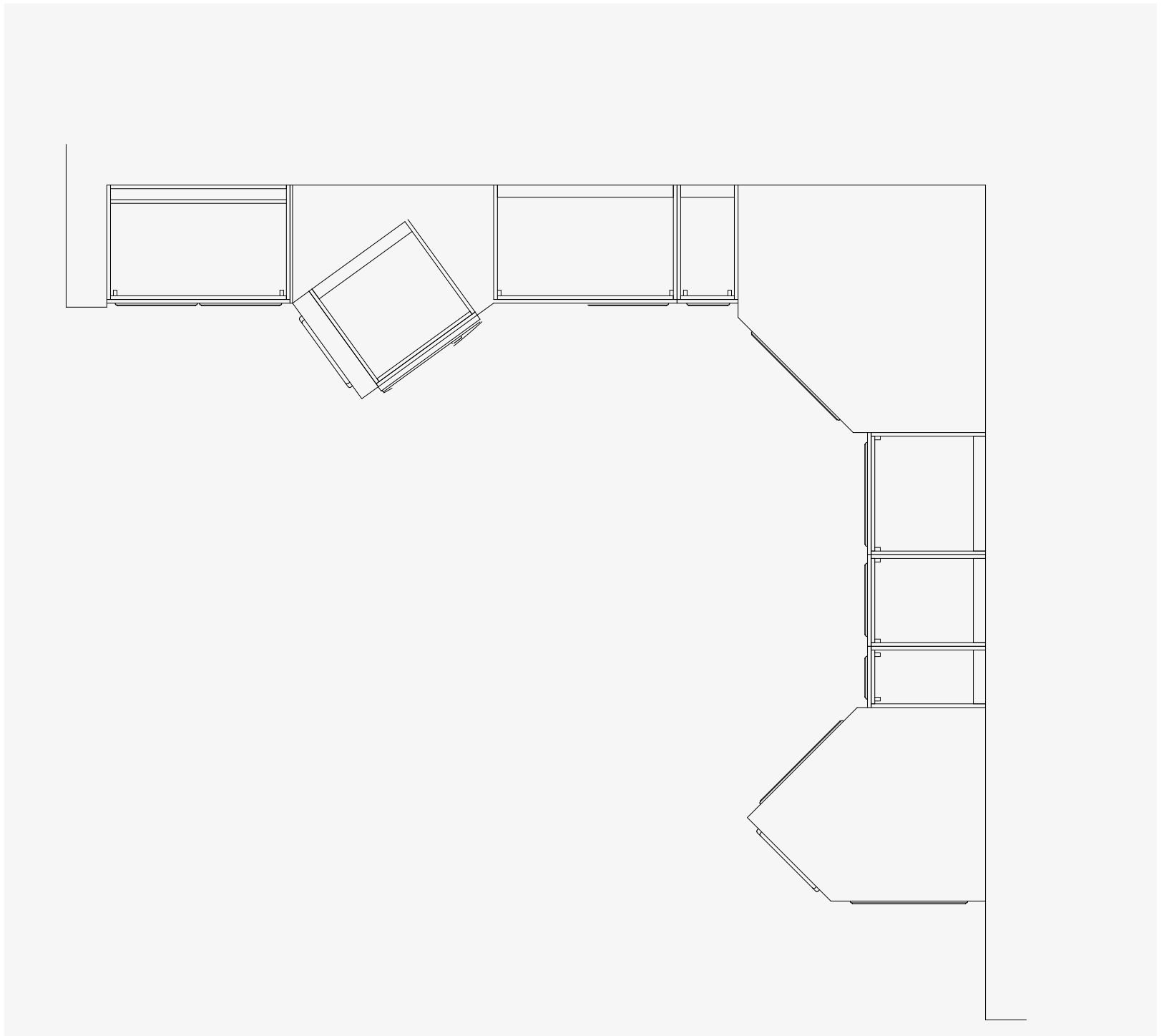

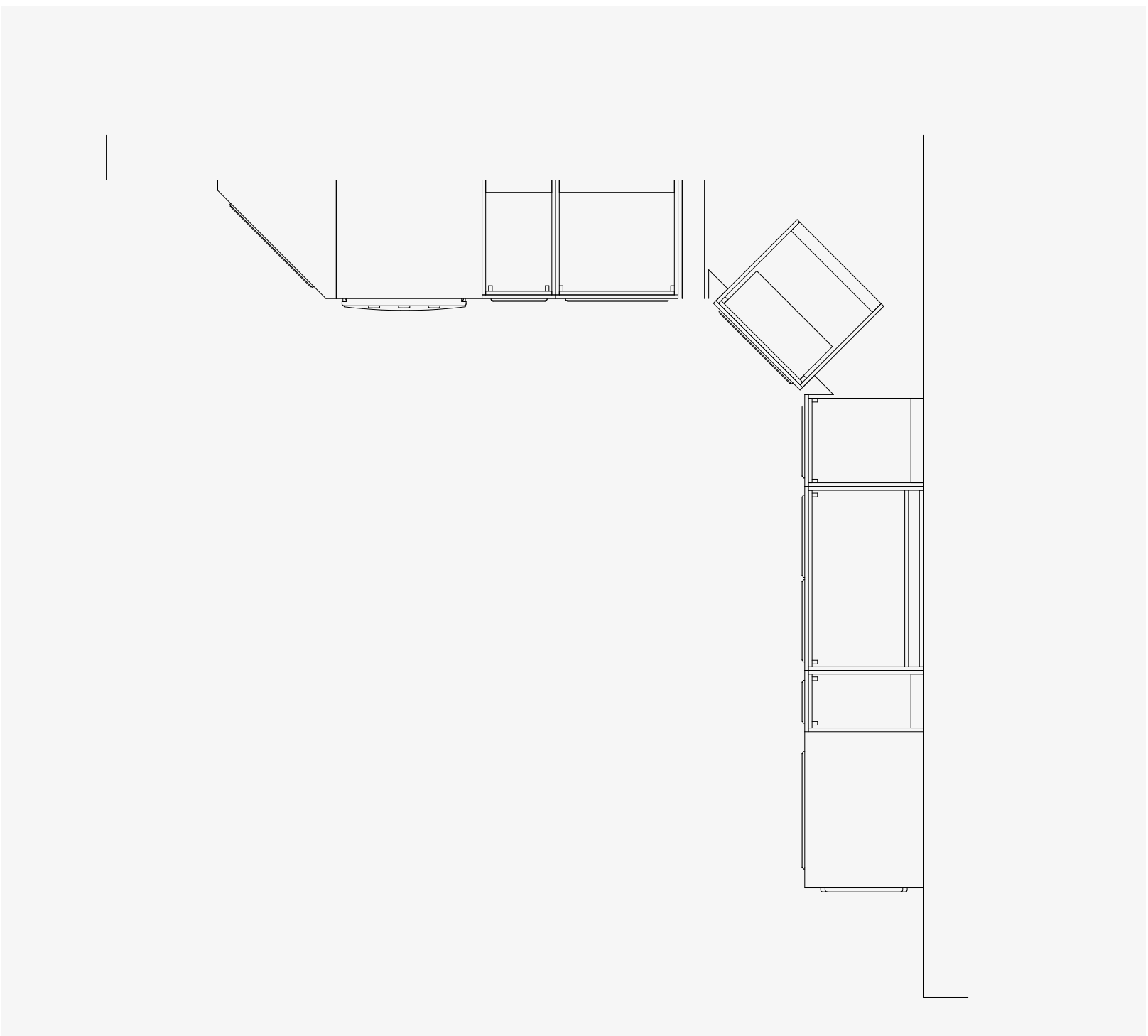
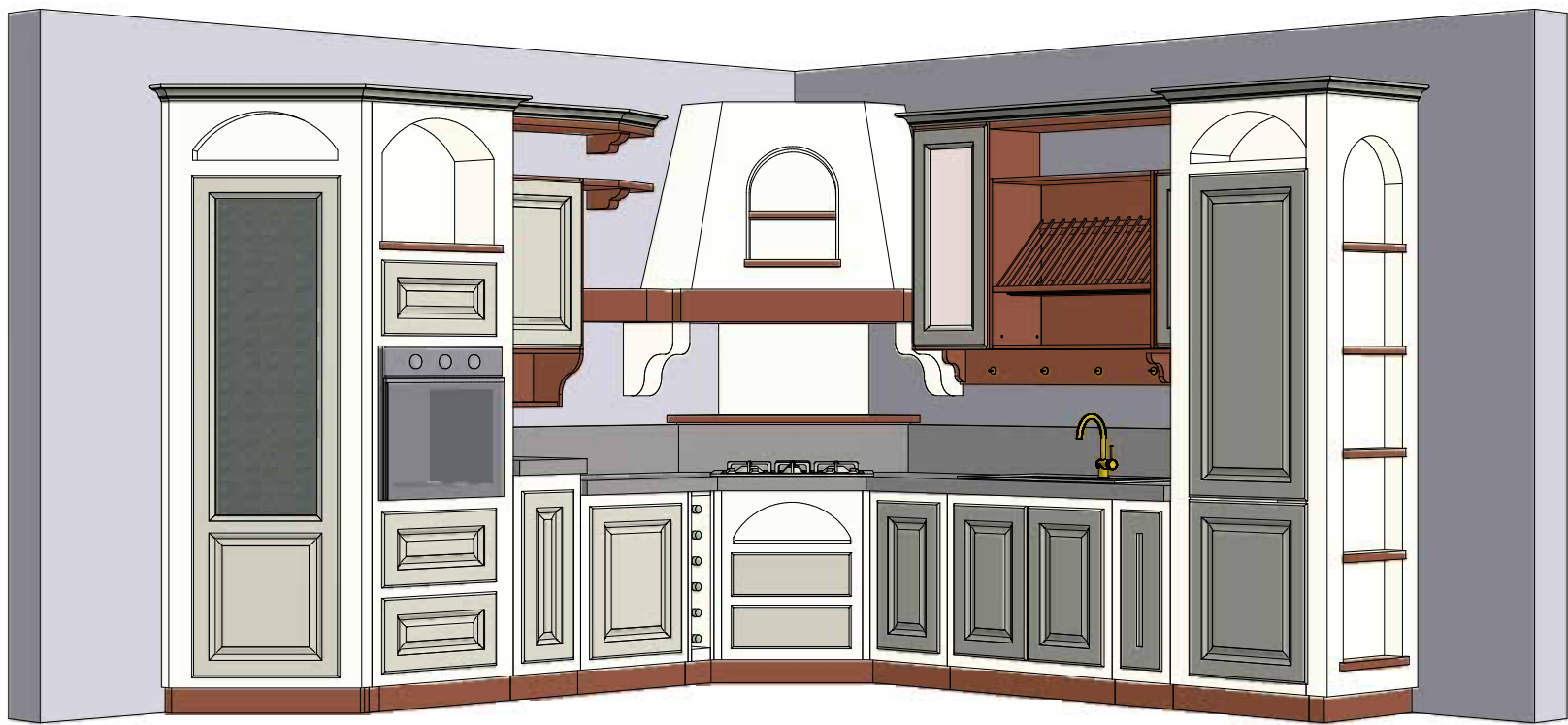

Composizione tipo / Composition type



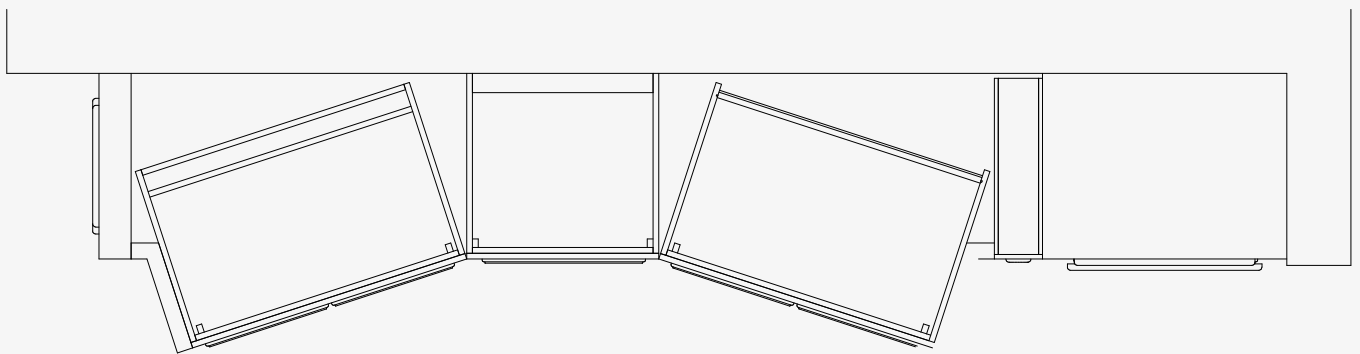
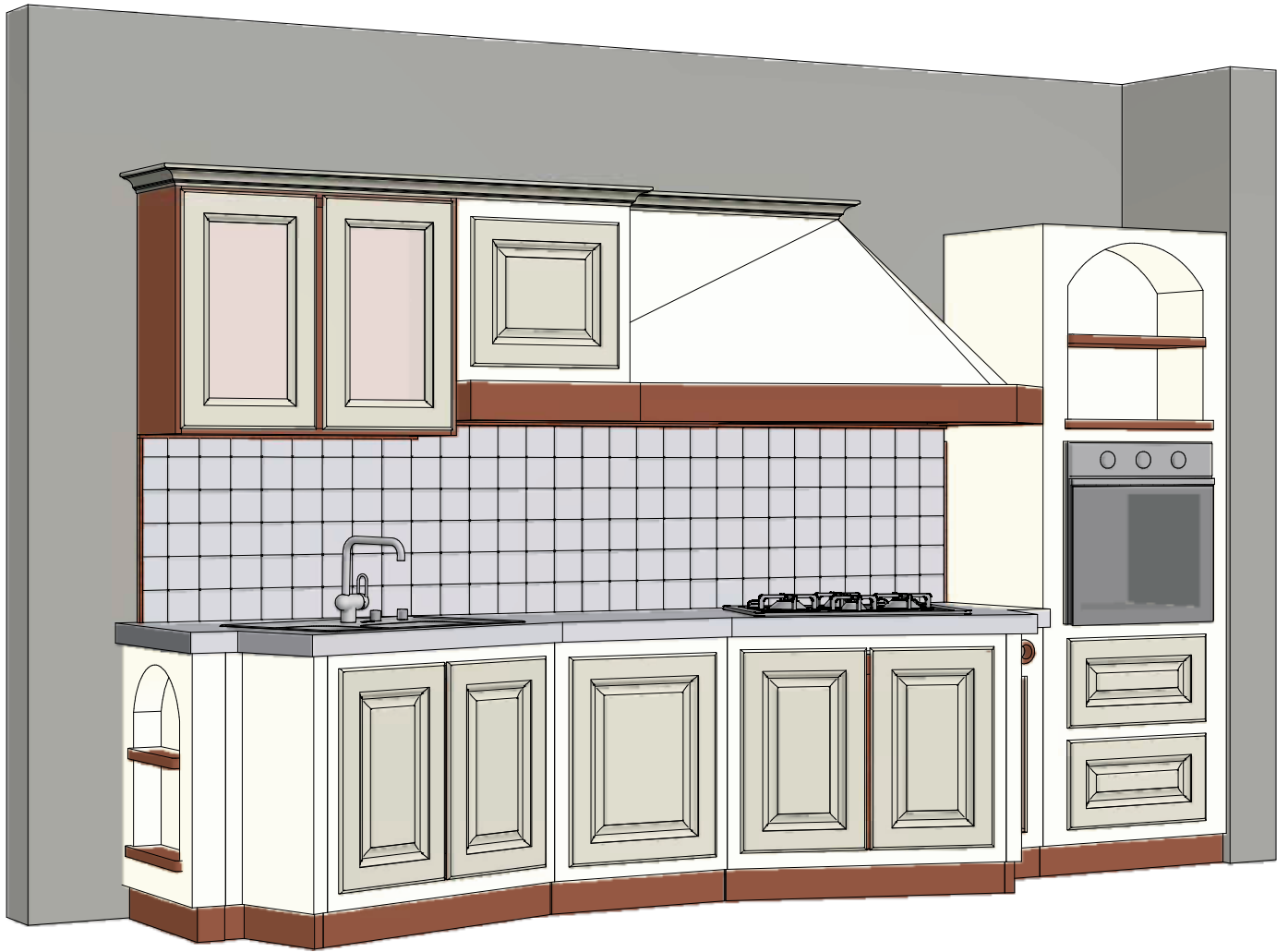

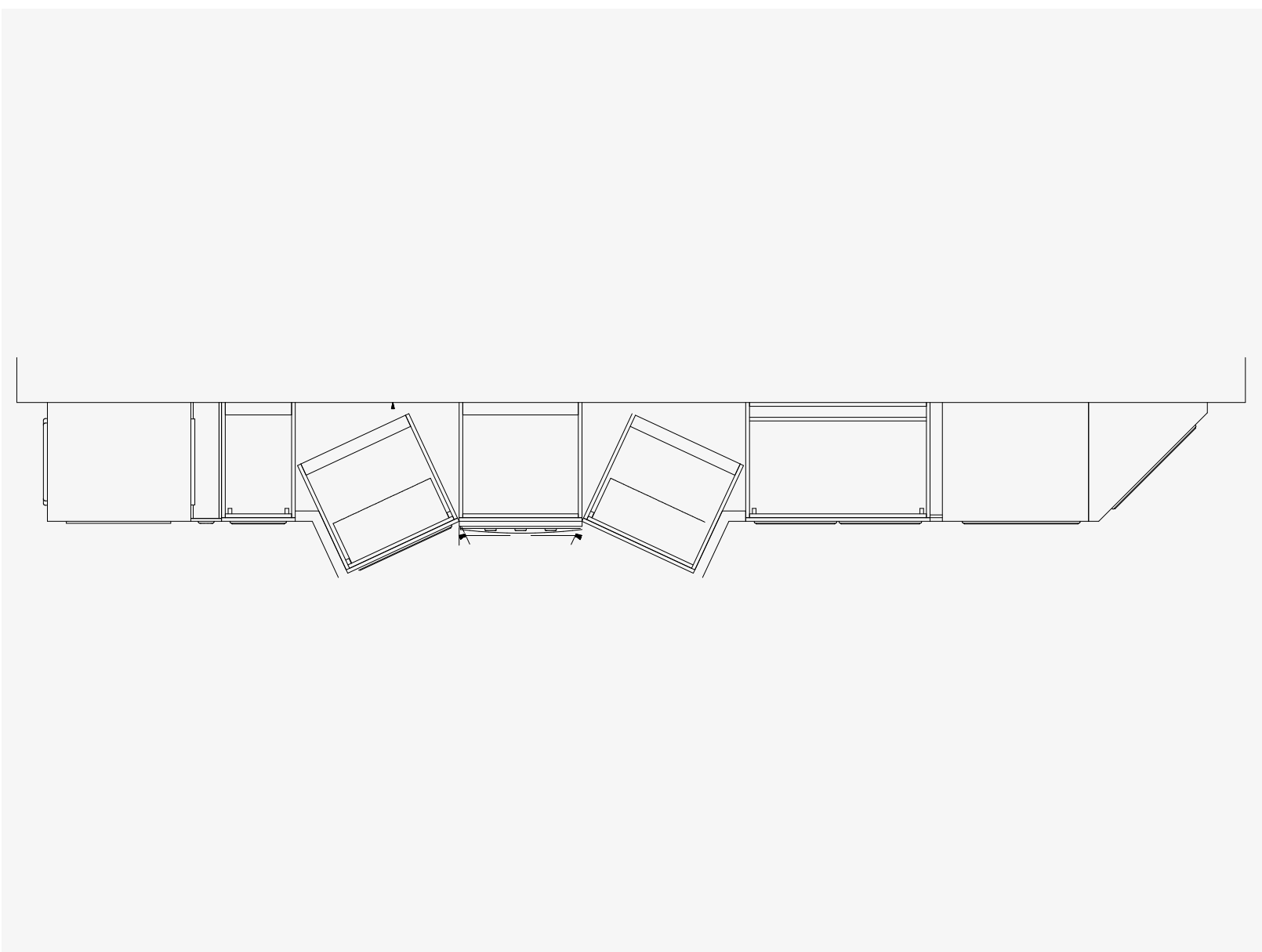

Composizione tipo / Composition type



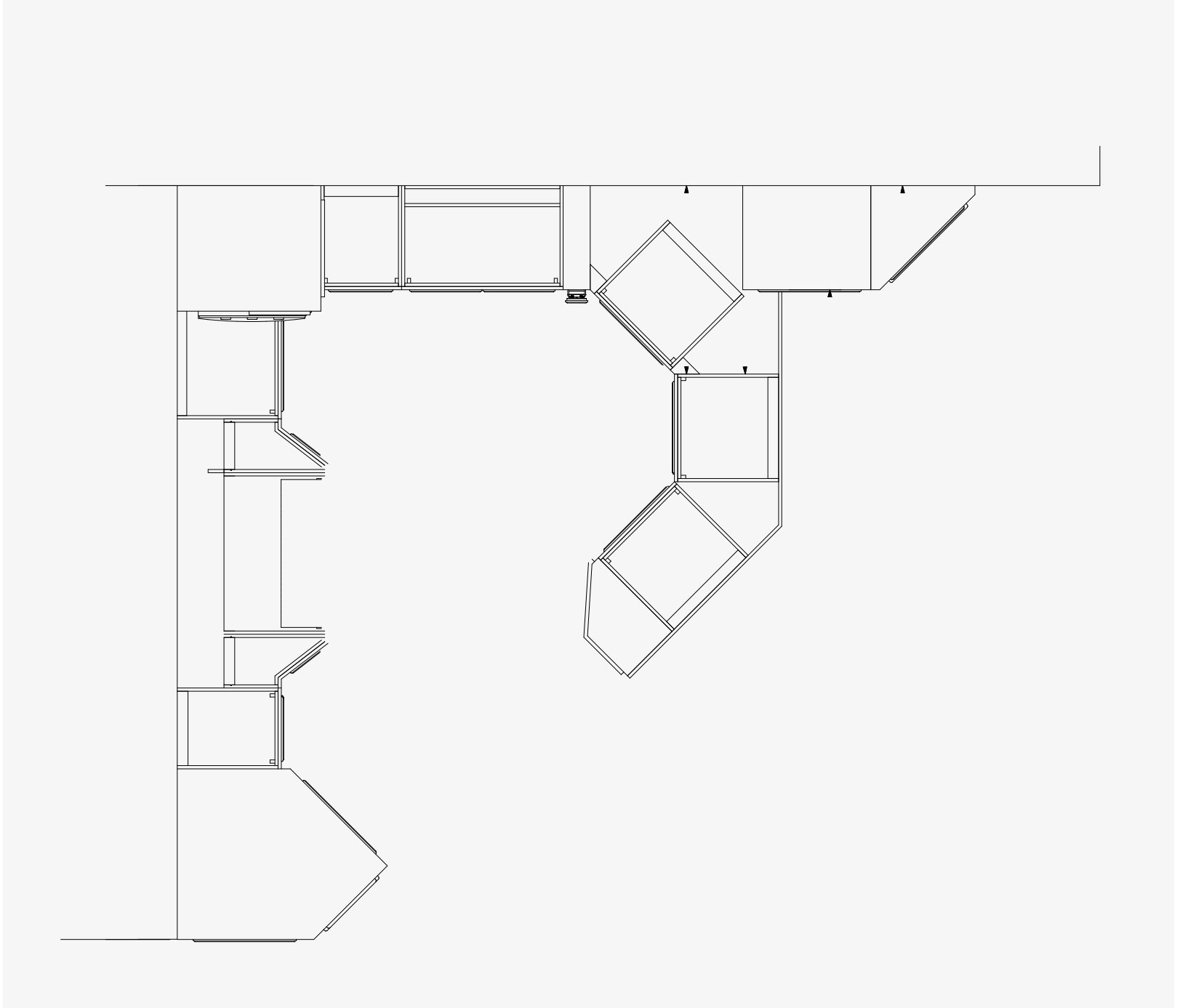
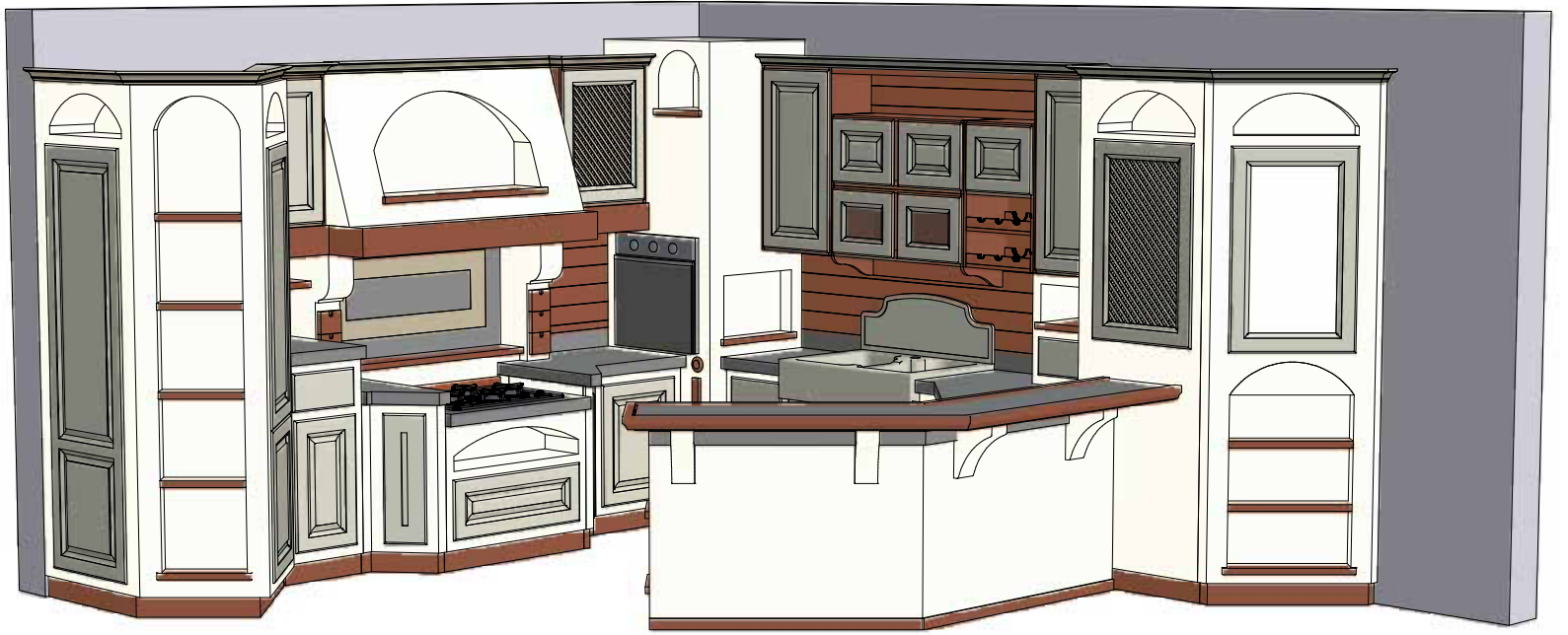

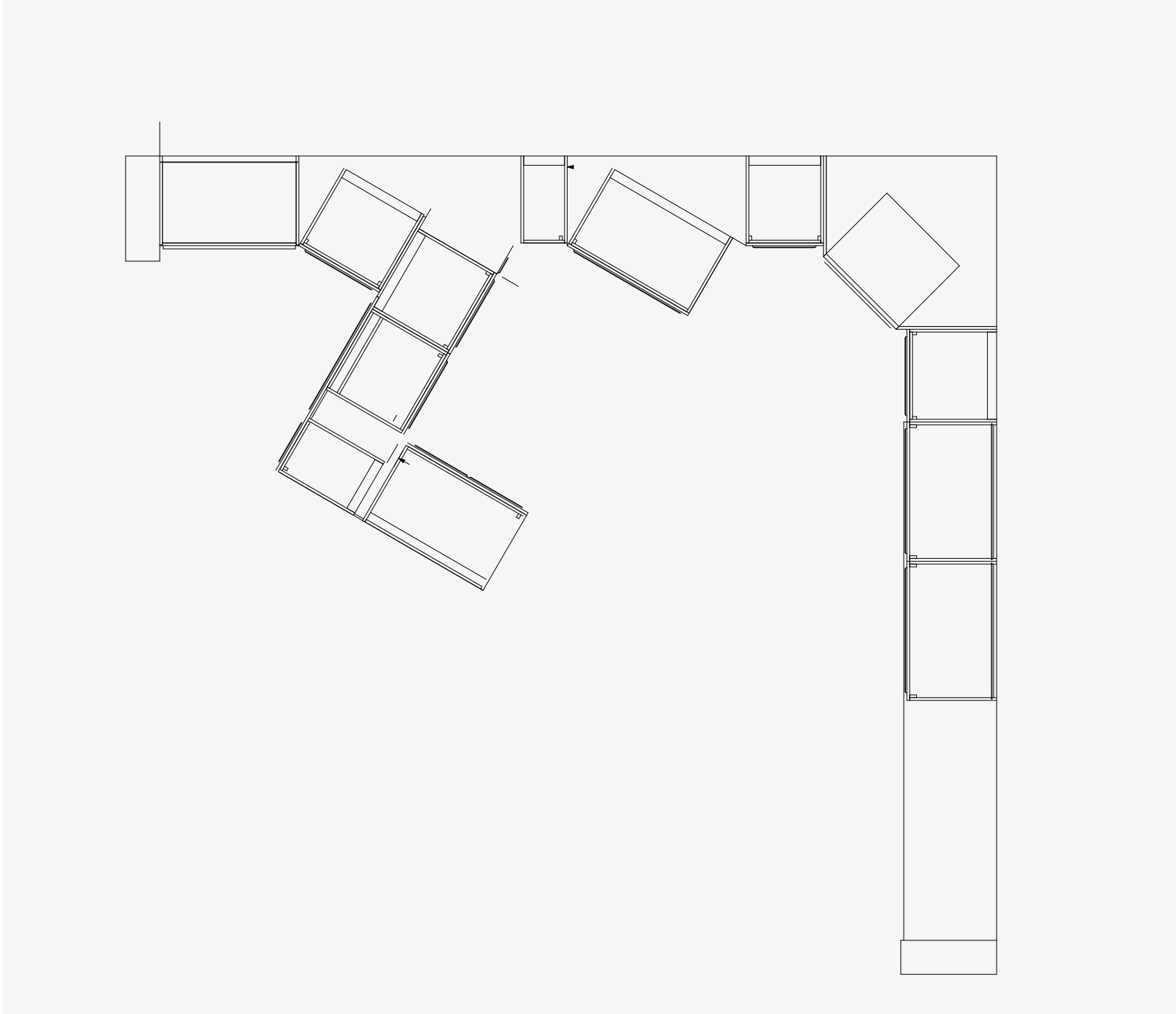
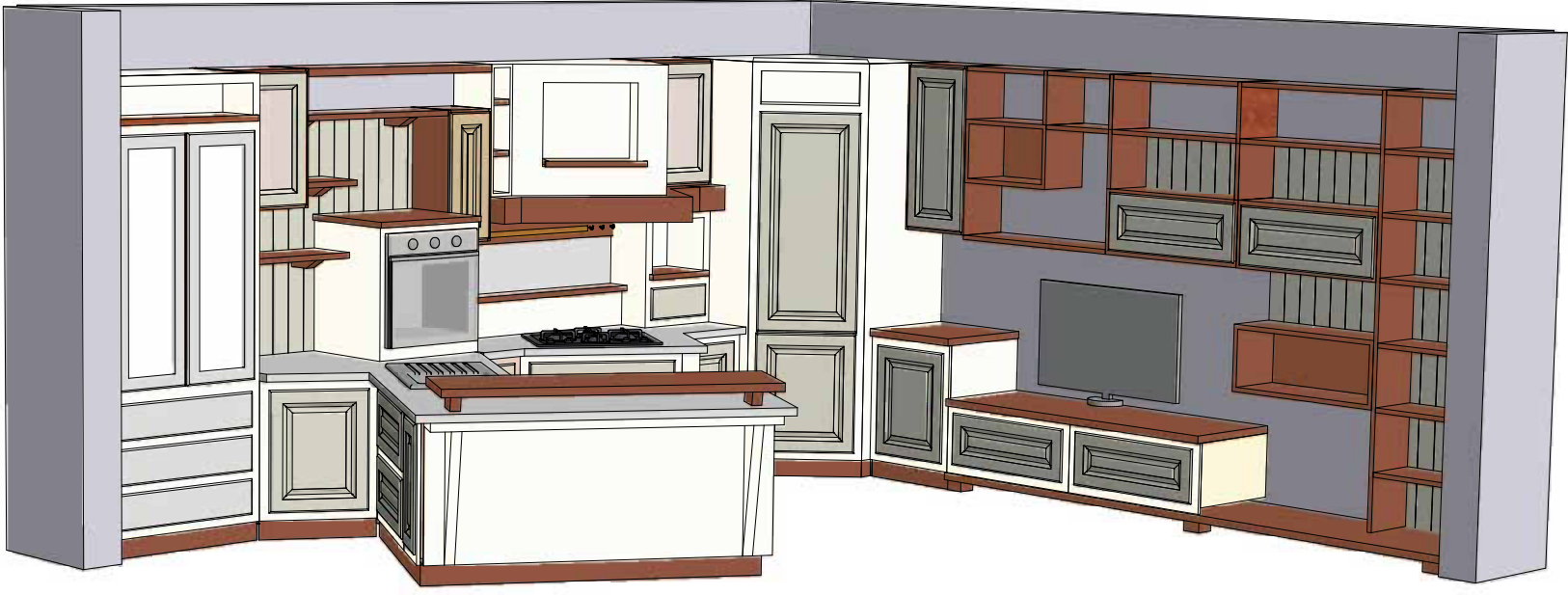

Composizione tipo / Composition type







140 ~ ELENA Bianco Shabby